

CP-8606

Sub. Code

23

B.Sc. DEGREE EXAMINATION, APRIL 2018

Second Semester

Interior Design

HISTORY OF INTERIOR DESIGNING

(Upto 2015 batch)

Time : 3 Hours

Maximum : 60 Marks

Part A

(5 × 2 = 10)

Answer **all** questions.

1. (a) What are the principles of interior design?

Or

(b) What are the different themes and concepts used in Interior design?

2. (a) What are the factors influencing Byzantine architecture?

Or

(b) Write any two architectural features of St. Vitale and Ravenna.

3. (a) What is Mahayana Buddhism?

Or

(b) Explain any two salient features of Chaitya Hall.

4. (a) Mention any two works of Charles Correa.

Or

- (b) Write any two philosophies of Louis Sullivan.

5. (a) What is neo-classical architecture?

Or

- (b) Mention any two building examples of Indo-Sarcenic architecture.

Part B

(5 × 10 = 50)

Answer **all** questions.

6. (a) Explain in detail the process of Interior Design.

Or

- (b) How themes and concepts play an important role in Interior design? Explain in detail.

7. (a) Explain in detail the evolution of church forms.

Or

- (b) Explain the architectural characteristics of St. Mark, Venice.

8. (a) What are the different buildings that got evolved during Ashoka's rule and its importance?

Or

- (b) Describe briefly about the architecture characteristics of Sanchi Stupa.

9. (a) Explain in detail the ideologies and philosophies of any two architects.

Or

- (b) Explain in detail the works of Laurie Baker.

10. (a) Describe briefly about neo-classical architecture with examples.

Or

- (b) Explain in detail the works of Chisholm.
-

CP-8607

Sub. Code

24

B.Sc. DEGREE EXAMINATION, APRIL 2018

Second Semester

Interior Design

COMPUTER BASICS — PRACTICAL

(Upto 2015 batch)

Time : 3 Hours

Maximum : 60 Marks

Part A

(5 × 2 = 10)

Answer **all** questions.

1. (a) Explain input devices.

Or

(b) Explain types of computer.

2. (a) Explain mail merge.

Or

(b) Explain footer and header.

3. (a) Explain table insecting.

Or

(b) Explain how to create style.

4. (a) Explain animation.

Or

(b) Explain types of tool bar.

5. (a) What are network protocols?

Or

(b) What is networking?

Part B

(5 × 10 = 50)

Answer **all** questions.

6. (a) Explain computer application to business.

Or

(b) Explain characteristics of computer.

7. (a) Explain creating styles.

Or

(b) Explain how to work with document.

8. (a) Explain table and data validation.

Or

(b) Explain how to work with sheets.

9. (a) Explain different types of animation.

Or

(b) Explain the steps to do a presentation.

10. (a) What are the types of network architectures?

Or

(b) Explain different types of topologies

CP-8608

Sub. Code

25

B.Sc. DEGREE EXAMINATION, APRIL 2018

Second Semester

Interior Design

DRAFTING FOR INTERIORS – PRACTICAL

(Upto 2015 batch)

Time : 3 Hours

Maximum : 60 Marks

The examiner should cut and give one question to each candidate from lot.

1. Draft a 20' × 16' Dining hall. Draw the following:
 - (a) Plan with furniture layout.
 - (b) One point perspective of the room.
 - (c) Write short notes on arches.
 - (d) Draw plumbing material chart.

----- cut here -----

2. Draft a 40' × 40' showroom.
 - (a) Draw plan with furniture layout.
 - (b) Two point perspective of the room.
 - (c) Short notes on false ceiling.
 - (d) Explain basic architectural symbols.

3. Draft a 16' × 16' bedroom (Kid). Draw the follow:

- (a) Plan with furniture layout.
- (b) One point perspective of the room.
- (c) Explain electrical fitting used with sketches.
- (d) Explain isometric view with examples.

----- cut here -----

4. Draft a master bedroom of 16' × 20'. Draw the following:

- (a) Plan and furniture layout.
- (b) One point perspective of the room.
- (c) Write about wall finishes.
- (d) Short notes on electrical accessories.

----- cut here -----

5. Draft a scavenger room of 12' × 16'. Draw the following:

- (a) Plan and furniture layout.
- (b) Two point perspective view of the room.
- (c) Explain the types of staircase.
- (d) Draw electrical symbols.

CP-8609

Sub. Code

41

B.Sc. DEGREE EXAMINATION, APRIL 2018**Fourth Semester****Interior Design****FURNITURE DESIGN****(Upto 2015 batch)**

Time : 3 Hours

Maximum : 60 Marks

Part A

(5 × 2 = 10)

Answer **all** questions.

1. (a) What is miter joint?

Or

(b) What are types of wall panelling?

2. (a) Define partition.

Or

(b) Define carpentry.

3. (a) What is a non load bearing partion?

Or

(b) Draft a chair (SCALE 1 :16).

4. (a) Sketch a stool.

Or

(b) Kitchen – Working triangle.

5. (a) Sketch tongue and grove.

Or

- (b) Draw a coffee table.

Part B

(5 × 10 = 50)

Answer **all** questions.

6. (a) Explain wooden partition.

Or

- (b) Explain fabric panelling with supporting sketches.

7. (a) What are tools used in carpentry?

Or

- (b) Draft a modular kitchen according to an appropriate scale.

8. (a) Explain lengthening joints.

Or

- (b) Explain widening joints.

9. (a) Sketch Victorian furniture (6 Nos).

Or

- (b) Explain glass partition.

10. (a) Explain the anthropometric data of various arrangements in the living room.

Or

- (b) Explain the types of wall panelling.

CP-8610

Sub. Code

42

B.Sc. DEGREE EXAMINATION, APRIL 2018

Fourth Semester

Interior Design

MATERIAL SCIENCE - II

(Upto 2015 batch)

Time : 3 Hours

Maximum : 60 Marks

Part A

(5 × 2 = 10)

Answer **all** questions.

1. (a) What are the various uses of stones?

Or

(b) Give classifications, qualities and uses of the following stones.

(i) Granite

(ii) Marble.

2. (a) Define shoring.

Or

(b) Give sketches of cantilever scaffolding.

3. (a) Mention the uses of plastics.

Or

(b) State the advantages of plywoods.

4. (a) State the general properties of glass.

Or

(b) Give an introduction of metals.

5. (a) Differentiate between lantern and skylight.

Or

(b) Give sketches of Gable window.

Part B

(5 × 10 = 50)

Answer **all** questions.

6. (a) What are the qualities of a good building stones.

Or

(b) What are the various commonly used building stones?

7. (a) Describe the different types of scaffolding with sketches.

Or

(b) Give sketches of shoring.

8. (a) What are the advantages and disadvantages of plastics?

Or

(b) State the market forms of plywood and explain its types.

9. (a) State the raw material required in the manufacture of different types of glass.

Or

(b) Describe the various types of metals.

10. (a) Give a list of fixtures and fastening which are commonly used for doors and windows.

Or

- (b) Explain different types of doors with sketches.
-

CP-8611

Sub. Code

43

B.Sc. DEGREE EXAMINATION, APRIL 2018.

Fourth Semester

Interior Design

BUILDING CONSTRUCTION

(Upto 2015 Batch)

Time : 3 Hours

Maximum : 60 Marks

Part A

(5 × 2 = 10)

Answer **all** questions.

1. (a) Write short notes on Timber partitions.
Or
(b) What is meant by seasoning of Timber.
2. (a) State the advantages of framed structures.
Or
(b) What is the difference between pre-cast and cast-in-situ concrete?
3. (a) Describe the roof coverings which are commonly used for pitched roofs.
Or
(b) Define roofs and explain the classification of roofs.
4. (a) Enumerate the different types of paints.
Or
(b) Mention the objects of providing pointing and plastering to the exposed surfaces.

5. (a) What are the requirements of formwork.

Or

- (b) Write short notes on formwork for floors.

Part B (5 × 10 = 50)

Answer **all** questions.

6. (a) State the advantages and disadvantages of timber construction.

Or

- (b) Give sketches of wooden joints.

7. (a) What are the causes of concrete floor cracks? Suggest the precautions to be taken to avoid such cracks.

Or

- (b) What is meant by a framed structure? What are its advantages?

8. (a) What are the different types of trusses. Explain with sketches.

Or

- (b) What factors should be considered while selecting a roof covering? Describe the roof coverings which are commonly used.

9. (a) Discuss the mortars which are used for pointing and plastering.

Or

- (b) Explain the characteristics of an ideal paint and what are the ingredients of a paint.

10. (a) What are the different types of centering. Explain with sketches.

Or

- (b) What are the advantages of steel formwork over timber formwork?
-

CP-8612

Sub. Code

44

B.Sc. DEGREE EXAMINATION, APRIL 2018

Fourth Semester

Interior Design

AUTOCAD II - (PRACTICAL)

(Upto 2015 Batch)

Time : 3 Hours

Maximum : 60 Marks

Design an office space for an advocate.

1. Draft the plan with zones. (5)
2. Write the furniture requirements. (5)
3. Draft the furniture layout. (10)
4. Brief the concept. (5)
5. Sections 4 sections. (35)

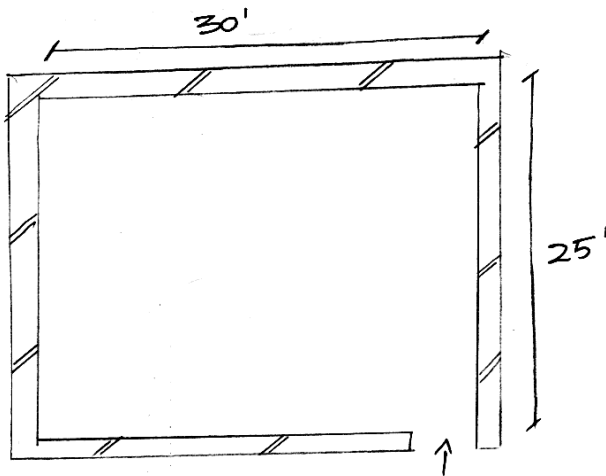

CP-8613

Sub. Code

45

B.Sc. DEGREE EXAMINATION, APRIL 2018

Fourth Semester

Interior Design

DESIGN STUDIO – II – PRACTICAL

(Upto 2015 Batch)

Time : 3 Hours

Maximum : 60 Marks

Answer all questions.

Part A

(2 × 5 = 10)

1. Brief the requirements of an office space.
2. Explain 'concept' and how a concept is being used in the interior space.

Part B

(50)

3. Design a theme restaurant 25' × 30'.
 - (a) Floor plan with furniture layout.
 - (b) Explain the theme of the restaurant.
 - (c) Perspective / Isometric view (any 1)
 - (d) False ceiling layout.
-

CP-8614

Sub. Code

61

B.Sc. DEGREE EXAMINATION, APRIL 2018

Sixth Semester

Interior Design

LANDSCAPE DESIGN

(Upto 2015 batch)

Time : 3 Hours

Maximum : 60 Marks

Part A

(5 × 2 = 10)

Answer **all** questions.

1. (a) What is line in a Landscape?
Or
(b) What is a ground cover form in Landscape?
2. (a) Define Shrub Form in Landscape design.
Or
(b) What is organic edges in Landscape design?
3. (a) What is green architecture?
Or
(b) What is sustainable design in green designing?
4. (a) What is geo technical site investigation?
Or
(b) What is Site Reconnaissance?

5. (a) What are the elements in Site and Surroundings that can add distinctive character to the space in apartments?

Or

- (b) What are the types in Landscaping?

Part B (5 × 10 = 50)

Answer **all** questions.

6. (a) Give a detailed account on landscape conservation in India.

Or

- (b) Explain about the Relationship of nature and landscape with suitable sketches.

7. (a) Explain in detail about plant breeding and genetics.

Or

- (b) Explain about crop improvement selection methods suitable diagram.

8. (a) Explain with suitable sketches the salient features of Moghul gardens of India.

Or

- (b) Explain with suitable illustration the salient features of Italian gardens.

9. (a) Explain in detail the method of site investigation appraisal and site planning.

Or

- (b) Explain the Environmental site appraisal procedure.

10. (a) With neat sketch explain the landscaping for Flats.

Or

(b) With neat sketch explain the landscaping for farm houses.

CP-8615

Sub. Code

62

B.Sc. DEGREE EXAMINATION, APRIL 2018

Sixth Semester

Interior Design

SCIENCE OF VAASTU

(Upto – 2015 batch)

Time : 3 Hours

Maximum : 60 Marks

Part A

(5 × 2 = 10)

Answer **all** questions.

1. (a) Give the traditional definition of Vaastu.

Or

- (b) What is Vasstupurusha Mandala?

2. (a) Give any two symptoms of positive energy in a building.

Or

- (b) What is micro enclosed spaced in a building.

3. (a) What is Agni Corner in Vaastu?

Or

- (b) What is Jala corner in Vaastu?

4. (a) What are the parameter as per Vaastu to be for Main door entrance of a house which is of South facing.

Or

- (b) What is 'Pada' in Vaastu?

5. (a) Give the Shui-yin and yang theory applied to bed room of a house.

Or

- (b) What is the principle of Shui-yin and yand theory for kitchen of a house?

Part B

(5 × 10 = 50)

Answer ALL questions.

6. (a) Explain the relationship of Vaastu to earth and give various classification of Vaastu.

Or

- (b) Explain in detail the significance of Vaastu purusha Mandala?

7. (a) Explain in detail the features of good building site with respect to building shapes.

Or

- (b) Explain in detail the relationship between built space and living organism.

8. (a) List out any ten important hints on planning based on Vaastu for location of Roms.

Or

- (b) List out any ten important hints on planning based on Vaastu for location of kitchen of a building.

9. (a) List out the Remedies for a South facing house as per Vaastu.

Or

- (b) List out the Vaastu parameters for a East facing building.

10. (a) Enlist the principle of Shin–yin and yang theory for bath rooms.

Or

- (b) Enlist the principles of Shin–yin–and yang theory for shops.
-

CP-8616

Sub. Code

63

B.Sc. DEGREE EXAMINATION, APRIL 2018

Sixth Semester

Interior Design

HUMAN RESOURCE MANAGEMENT

(Upto 2015 batch)

Time : 3 Hours

Maximum : 60 Marks

Part A

(5 × 2 = 10)

Answer **all** questions.

1. (a) List any two objectives of personnel management.

Or

- (b) Give any two functions of personal manager.

2. (a) What is personal interview?

Or

- (b) What do you mean by 'GD' in Interview?

3. (a) What is performance appraisal?

Or

- (b) What is on the Job training?

4. (a) List out any two types of motivation.

Or

- (b) Define productivity.

5. (a) What is Labour turnover?
Or
(b) What is retention profile?

Part B (5 × 10 = 50)

Answer **all** questions.

6. (a) Elaborate on the important role of personnel manager in an Industry.
Or
(b) Enlist the scope of personnel management in India.
7. (a) Explain the steps in recruitment and selection process for a multinational company.
Or
(b) Explain about Job analysis and Job satisfaction.
8. (a) Explain various types of performance appraisal followed in Industry.
Or
(b) Explain different types of training adopted in a company.
9. (a) Explain the motivation process and its types.
Or
(b) Explain various steps adopted in industry to increase productivity.
10. (a) Explain the measurement of labour turnover.
Or
(b) Explain the theoretical model for counselling.