

**C-3346**

**Sub. Code**

**91913**

**B.Sc. DEGREE EXAMINATION**

**INTERIOR DESIGN**

**APRIL 2021 EXAMINATION**

**&**

**APRIL 2020 ARREAR EXAMINATION**

**First Semester**

**THEORY OF DESIGN**

**(2018 onwards)**

Duration : 3 Hours

Maximum : 75 Marks

**Part A**

(10 × 2 = 20)

Answer **all** questions.

1. List any four elements of design.
2. List an four principles of design
3. What is anthropometry?
4. What are the types of balance?
5. What is Gestalt theory.
6. What is design process?
7. What are the steps involved in the design process?
8. What is spatial organisation?
9. What is ergonomics?
10. What is golden section?

**Part B**

(5 × 5 = 25)

Answer **all** questions.

11. (a) Write a note on scale and proportion.

Or

- (b) Gestalt theory.

12. (a) Write a note on ideation in design process.

Or

- (b) What is contemporary style?

13. (a) Golden section.

Or

- (b) Lines and types of lines: Brief.

14. (a) Design philosophy.

Or

- (b) Brief figure and ground principle.

15. (a) Write a note on emphasis.

Or

- (b) Write a note on style. Mention some examples.

**Part C**

(3 × 10 = 30)

Answer **all** questions.

16. (a) Explain the principles of design.

Or

- (b) Explain the importance of colours and its impact in interior space.

17. (a) Explain the elements of design.

Or

(b) Explain design history.

18. (a) Explain the design process.

Or

(b) Explain anthropometry.

---

**C-3347**

**Sub. Code**

**91923**

**B.Sc. DEGREE EXAMINATION**

**INTERIOR DESIGN**

**APRIL 2021 EXAMINATION**

**&**

**APRIL 2020 ARREAR EXAMINATION**

**Second Semester**

**ELEMENTS OF INTERIOR SPACES**

**(2018 onwards)**

Duration : 3 Hours

Maximum : 75 Marks

**Part A**

(10 × 2 = 20)

Answer **all** questions.

1. What is a texture?
2. What is a cornice?
3. What is a moulding?
4. What are skylights?
5. What is a false ceiling?
6. What are the types of lighting?
7. What are doors?
8. What are windows?
9. Draw a ventilator
10. What is a flooring?

**Part B**

(5 × 5 = 25)

Answer **all** questions, choosing either (a) or (b).

11. (a) Write a note on beam and column.

Or

- (b) What are types of mouldings?

12. (a) Brief the types of artificial lighting.

Or

- (b) Write a brief note on resilient flooring.

13. (a) Draw the parts of a door.

Or

- (b) Draw the parts of a window.

14. (a) What are the types of roofs?

Or

- (b) Write any five advantages of flat roof.

15. (a) Write a brief note on ventilator.

Or

- (b) Write the importance of false ceiling.

**Part C**

(3 × 10 = 30)

Answer **all** questions, choosing either (a) or (b).

16. (a) Explain any five types of windows with diagrams.

Or

- (b) Explain the advantages and disadvantages of flat roof.

17. (a) Explain any five types of doors with diagrams.

Or

(b) Explain lighting.

18. (a) Explain the materials for flooring.

Or

(b) Explain false ceiling.

---

**C-3356**

**Sub. Code**

**91924**

**B.Sc. DEGREE EXAMINATION**

**INTERIOR DESIGN**

**APRIL 2021 EXAMINATION**

**&**

**APRIL 2020 ARREAR EXAMINATION**

**Second Semester**

**COMPUTER BASICS – PRACTICAL**

**(Upto 2015 Batch)**

Duration : 3 Hours

Maximum : 60 Marks

**Part A**

(5 × 2 = 10)

Answer **all** questions by choosing either (a) or (b)

1. (a) List the computer types.  
Or  
(b) Write the generation of computers.
2. (a) What is text formality in MS word?  
Or  
(b) What are file operations in MS word?
3. (a) What is data base?  
Or  
(b) How to validate the data in MS excel?
4. (a) Write the basics of MS power point.  
Or  
(b) How to animate the slide in MS power point?

5. (a) List the types of network.

Or

- (b) What is network architecture?

**Part B**

(5 × 10 = 50)

Answer **all** questions by choosing either (a) or (b).

6. (a) Explain the application of computer in business.

Or

- (b) Discuss the anatomy of digital computer.

7. (a) Explain the advanced formatting commands and their usage.

Or

- (b) Explain the procedure to perform page design with suitable example.

8. (a) Explain the procedure to create a graphic object chart with suitable example.

Or

- (b) Discuss the various functions in MS Excel and their usage.

9. (a) Prepare a presentation about four goals using 6 slides.

Or

- (b) Explain the various animation commands in MS power point.



10. (a) Explain the various types of network.

Or

(b) Discuss in detail the communication medium.

---

**C-3348**

**Sub. Code**

**91932**

**B.Sc. DEGREE EXAMINATION**

**INTERIOR DESIGN**

**APRIL 2021 EXAMINATION**

**&**

**APRIL 2020 ARREAR EXAMINATION**

**Third Semester**

**INTERIOR SERVICES — I**

**(2018 onwards)**

Duration : 3 Hours

Maximum : 75 Marks

**Part A**

(10 × 2 = 20)

Answer **all** questions.

1. Define the types of piping system.
2. What is ventilation of sewers?
3. What is frequency in accoustics?
4. Name four important terms related to accoustics.
5. State the elements that control overall round absorption in a room.
6. What is reinforcement?
7. What are the caulking compounds?

8. Write short notes on water supply.
9. State any four insulation materials.
10. What is texture?

**Part B**

(5 × 5 = 25)

Answer **all** questions by choosing either (a) or (b).

11. (a) Explain the wall sound proofing materials used in interior design.

Or

- (b) Write short notes on the following :
  - (i) Traps
  - (ii) Sound intensity.

12. (a) Explain the supply of sound energy in relation with shape and volume of a interior room.

Or

- (b) Explain in detail which are the major defects should be avoided in recording room.

13. (a) Write short notes on the following ;
  - (i) Water dosets
  - (ii) Shower panel.

Or

- (b) Draw the rain water harvesting system and explain.

14. (a) Explain in detail how water level will be maintained in water tanks.

Or

- (b) Explain the recycling of water for various functions.

15. (a) Explain in detail of water supply and sanitary installations with illustrations.

Or

- (b) Draw the accoustic details of an auditorium.

**Part C**

(3 × 10 = 30)

Answer **all** questions by choosing either (a) or (b).

16. (a) Draw the commonly used sanitary fittings in a home with necessary drawings.

Or

- (b) Draw the plan of an auditorium for multi purpose and state the basic principles which are more important.

17. (a) Draw the plumbing working drawing for a small health center.

Or

- (b) Explain in detail of the following :

(i) Measurement of sound

(ii) Sound reinforcement

(iii) Drain pipes

(iv) Reception of sound.

18. (a) Draw the drainage system of your local place in detail.

Or

- (b) Explain in detail of the following :

(i) Solar system

(ii) Sound waves

(iii) Flushing cisterns

(iv) Obsorbtion of sound.

**C-3349**

**Sub. Code**

**91943**

**B.Sc. DEGREE EXAMINATION**

**INTERIOR DESIGN**

**APRIL 2021 EXAMINATION**

**&**

**APRIL 2020 ARREAR EXAMINATION**

**Fourth Semester**

**LIGHTING AND COLURS IN INTERIORS**

**(2018 onwards)**

Duration : 3 Hours

Maximum : 75 Marks

**Part A**

(10 × 2 = 20)

Answer **all** questions.

1. What is day light factor?
2. Define illumination
3. What are energy saving lamps?
4. Mention the units of measurements for light.
5. State the qualities of yellow.
6. Write about secondary colorus with examples.
7. Expand HPS lamps
8. Explain ceiling roses
9. What is meant by intensity in colour?
10. Give a short note on colour temperature.

**Part B**

(5 × 5 = 25)

Answer **all** questions.

11. (a) State the characteristics of day lighting.

Or

- (b) Write a brief note on skylights.

12. (a) Discuss the trends in incandescent lamps available in the market.

Or

- (b) How will you design lighting for different areas and activities?

13. (a) Explain the dimensions/attributes of colour.

Or

- (b) How will you create emphasis and proportion in interiors with use of colours?

14. (a) Compare direct and indirect lighting with illustrations.

Or

- (b) Express the psychological aspects of lights and its impact in human.

15. (a) Suggest the suitable lighting fixtures for reading and in entrance areas.

Or

- (b) Write a brief note on the benefits and application of lighting control systems.

**Part C**

(3 × 10 = 30)

Answer **all** questions.

16. (a) Why is the introduction of day lighting from side lights and top lights important? How are they different?

Or

- (b) Does the location and direction of lights decide on the lighting performance in interiors? Elaborate.

17. (a) Elaborate the impact of colours on human beings.

Or

- (b) Discuss the factors to be considered while choosing colour schemes.

18. (a) Enumerate on the Oswalt colour system.

Or

- (b) Explain briefly the various colour schemes.
-

**C-3350**

**Sub. Code**

**91944**

**B.Sc. DEGREE EXAMINATION**

**INTERIOR DESIGN**

**APRIL 2021 EXAMINATION**

**&**

**APRIL 2020 ARREAR EXAMINATION**

**Fourth Semester**

**INTERIOR SERVICES - II**

**(2018 onwards)**

Duration : 3 Hours

Maximum : 75 Marks

**Part A**

(10 × 2 = 20)

Answer **all** questions.

1. What is duct layout?
2. What are cooling towers?
3. What is fire compression foam composed of?
4. List the basic fire safety standards.
5. What is single phase?
6. Name any three protective devices in electrical installation.
7. What is the role of a fuse?
8. What is a main?
9. What are fixtures?
10. What is the role of evaporators in air conditioning?



**Part B**

(5 × 5 = 25)

Answer **all** questions by choosing either (a) or (b).

11. (a) Explain any three parts of an air conditioner.

Or

- (b) Write about vapour compression cycle.

12. (a) Enlist the concepts in fire protection.

Or

- (b) Write about smoke detectors and its working.

13. (a) Differentiate single and three phase supply.

Or

- (b) Describe the ISI specifications for electrical goods.

14. (a) Explain the types of wires.

Or

- (b) Write about main and distribution board.

15. (a) Explain

- (i) Fan coiled system and

- (ii) Cooling load.

Or

- (b) Explain any two types of air conditioners.

**Part C**

(3 × 10 = 30)

Answer **all** questions by choosing either (a) or (b).

16. (a) Discuss about the air conditioning systems for different types of buildings.

Or

- (b) Describe the mechanism of fire spread in a building and how can it be prevented.

17. (a) Explain about the wiring systems and their choice.

Or

(b) What are the points to be considered while planning electrical wiring for a building.

18. (a) Give the working drawing of various fittings and fixtures of electrical installation for a Hall.

Or

(b) Prepare a electrical layout of a single storey building.

---

**C-4633**

**Sub. Code**

**91961**

**B.Sc. DEGREE EXAMINATION**

**INTERIOR DESIGN**

**APRIL 2021 EXAMINATION**

**&**

**APRIL 2020 ARREAR EXAMINATION**

**Sixth Semester**

**INTERIOR PROJECT MANAGEMENT**

**(2018 onwards)**

Duration : 3 Hours

Maximum : 75 Marks

**Part A**

(10 × 2 = 20)

Answer **all** questions.

1. Define Project control.
2. What is event?
3. What is meant by project network?
4. Distinguish between direct project cost and indirect project cost.
5. What do you understand by the term cost optimization?
6. What is known as project updating?
7. Mention the purpose of using a histogram.
8. Define resource levelling.

9. Name the different types of estimates.
10. What are Specifications?

**Part B** (5 × 5 = 25)

Answer **all** questions, choosing either (a) or (b).

11. (a) Bring out the role of decision in project management.

Or

- (b) What are the disadvantages of traditional management system?

12. (a) Discuss on the steps involved in the numbering of events.

Or

- (b) Explain total project cost with examples.

13. (a) Explain the information which is necessary to update the project.

Or

- (b) Discuss the role of computers in efficient project management.

14. (a) What is GST? How is it calculated?

Or

- (b) Write the advantages and disadvantages of bill of quantities.

15. (a) What are the data required to estimate project cost?

Or

- (b) Why is work breakdown structure important to a project?

**Part C**

(3 × 10 = 30)

Answer **all** questions, choosing either (a) or (b).

16. (a) Explain the steps involved in project life cycle.

Or

- (b) What is the critical path method? Explain how to determine the critical path in project management?

17. (a) Describe the steps in the process of updating.

Or

- (b) Explain the method of project planning and programming.

18. (a) Enumerate the methods of measurements of different items of work.

Or

- (b) Explain the different methods of estimate prepared for interior design works.

**C-3318**

**Sub. Code**

**91911F/  
91811F**

**B.Sc. DEGREE EXAMINATION**

**(COMMON FOR B.SC. (INTERIOR DESIGN/FASHION  
DESIGN)**

**APRIL 2021 EXAMINATION**

**&**

**APRIL 2020 ARREAR EXAMINATION**

**First Semester**

**FRENCH — I**

**(Upto 2015 batch)**

Duration : 3 Hours

Maximum : 60 Marks

**Part A**

**(5 × 2 = 10)**

Answer **all** questions.

1. Translate in French :

(a) (i) Sir :

(ii) Madam :

Ou

(b) (i) Father :

(ii) Mother :

2. Reconstituez lesphrases. Ecoutez et Vérifiez, puis prononcez – les.

(a) service | á | votre.

Ou

(b) thé | votre | voilà.

3. Give indefinite articles for :

(a) un garçon.

Ou

(b) une fille.

4. Give definite articles for :

(a) le Père.

Ou

(b) le Frère.

5. Convert Masculine into Feminine in French :

(a) Aucun.

Ou

(b) Autre.

**Part B**

(5 × 10 = 50)

Answer **all** questions.

6. Apprenons le Français :

(a) (i) Salutations →

(ii) A bientôt! →

(iii) Bonjour! →

(iv) Bonne nuit! →

(v) Bon soir! →

Ou

- (b) (i) Ça va bin, merci et toi? →
- (ii) Comment allez – vous? →
- (iii) Comment ça va? →
- (iv) Comment tu t' appelles? →
- (v) À demain! →

7. (a) List out and explain different types fo pronouns in French grammar.

Ou

(b) Les presentations [Introduce yourself].

8. (a) Write any ten fruits name in French.

Ou

(b) Write any ten vegetables in French.

9. Give the French words for the following countries.

- (a) (i) India
- (ii) Japan
- (iii) Spain
- (iv) Sweden
- (v) Switzerland
- (vi) Havana
- (vii) Moscow
- (viii) Rome
- (ix) Paris
- (x) Egypt.

Ou



- (b) (i) Turkey
- (ii) United states
- (iii) England
- (iv) Geneva
- (v) Germany
- (vi) Norway
- (vii) Scotland
- (viii) Russia
- (ix) France
- (x) Italy.

10. (a) List out Days in a week in French.

Ou

(b) Write months of the year in French.

---

**C-3352**

**Sub. Code**

**91913**

**B.Sc. DEGREE EXAMINATION**

**INTERIOR DESIGN**

**APRIL 2021 EXAMINATION**

**&**

**APRIL 2020 ARREAR EXAMINATION**

**First Semester**

**HISTORY OF ART AND ARCHITECTURE**

**(Upto 2015 Batch)**

Duration : 3 Hours

Maximum : 60 Marks

**Part A**

(5 × 2 = 10)

Answer **all** questions choosing either (a) or (b).

1. (a) What is paleolithic architecture?  
Or  
(b) Write short notes on Neolithic architecture.
2. (a) What is the most famous example of Greek architecture?  
Or  
(b) What are the three orders of Greek architecture?
3. (a) What are the styles of Indian temple architecture?  
Or  
(b) What were the main features of Hindu architecture?

4. (a) Who started Dravidian architecture?

Or

(b) Which is the oldest temple in South India?

5. (a) Write about sun temple.

Or

(b) What do you mean by Indo-Aryan style.

**Part B** (5 × 10 = 50)

Answer **all** questions, by choosing either (a) or (b).

6. (a) Discuss on development of shelter related to prehistoric age.

Or

(b) Discuss the architectural features of Egyptian architecture in detail.

7. (a) Explain the architectural characteristics of Parthenon.

Or

(b) Explain the following:

(i) Doric

(ii) Ionic

(iii) Corinthian

8. (a) Explain early shrines of Gupta periods.

Or

(b) Explain the architectural characteristics of Virupaksha temple.

9. (a) Give the detailed description about the shore temple.

Or

(b) With suitable example, explain Dravidian architecture.

10. (a) Explain the architecture style of Kalinga.

Or

(b) Discuss the salient features of Indo-Aryan style architecture.

---

**C-3353**

**Sub. Code**

**91914**

**B.Sc. DEGREE EXAMINATION**

**INTERIOR DESIGN**

**APRIL 2021 EXAMINATION**

**&**

**APRIL 2020 ARREAR EXAMINATION**

**First Semester**

**BASIC PLANNING AND DESIGNING (P)**

**(Upto 2015 Batch)**

Duration : 3 Hours

Maximum : 60 Marks

**Part A**

(5 × 2 = 10)

Answer **all** questions.

1. (a) What is FPS system?

Or

(b) What is MKS system?

2. (a) What is lettering in drawing?

Or

(b) What are guidelines in lettering?

3. (a) Write the importance of interior design.

Or

(b) What is the concept of space planning in living room?

4. (a) How are dimensions listed for furniture?

Or

(b) List the types of dimensions.

5. (a) What are finishes in interior design?

Or

(b) What is plywood?

**Part B**

(5 × 10 = 50)

Answer **all** Questions.

6. (a) Explain the various tools used for engineering drawing.

Or

(b) Draw the plan and elevation of a chain of size 3'0" x 3' 0" with the help of T scale and set square.

7. (a) Elaborate the application of lines in engineering drawing.

Or

(b) Write short notes on single stroke lettering and gothic lettering.

8. (a) Design a space planning for kitchen of your choice as per suitable requirements.

Or

(b) Write short notes on floor plan for a living room.

9. (a) Draw the following furnitures with dimensions.

(i) Coffee table

(ii) Arm chair

(iii) Dining table

Or

(b) Write short notes on one wall elevation.

10. (a) Explain plywoods and its related products.

Or

(b) Explain paints and its related products.

---

**C-3354**

**Sub. Code**

**91915**

**B.Sc. DEGREE EXAMINATION**

**INTERIOR DESIGN**

**APRIL 2021 EXAMINATION**

**&**

**APRIL 2020 ARREAR EXAMINATION**

**First Semester**

**ELEMENTS OF DESIGN – PRACTICAL**

**(Upto 2015 Batch)**

Duration : 3 Hours

Maximum : 60 Marks

**Part A**

**(5 × 3 = 15)**

Answer **all** questions.

1. Construct a Pentagon.
2. Draw a window grill.
3. Do a free hand drawing of a garden environment.
4. Draw a cylinder with shades and shadows.
5. Draw the plan and elevation of a 'Table'.



**Part B**

(45 Marks)

Answer **all** questions.

6. Draw the different types of doors and windows of standard size with measured scale. (10)
  7. Draw plan and front elevation of a room of size  $10' \times 18'$  (25)
  8. Explain briefly about Isometric projection of different objects with neat measured drawings. (10)
-

**C-3357**

**Sub. Code**

**91925**

**B.Sc. DEGREE EXAMINATION**

**ID**

**APRIL 2021 EXAMINATION**

**&**

**APRIL 2020 ARREAR EXAMINATION**

**Second Semester**

**DRAFTING FOR INTERIORS - PRACTICAL**

**(Upto 2015 batch)**

Duration : 3 Hours

Maximum : 60 Marks

The Examiner should cut and give ONE question to each candidate.

1. Draft a 4'6" × 6'0" bathroom.
  - (a) Plan with fittings.
  - (b) Choose a flooring material and render the plan with the same.
  - (c) Draft the front and back elevation of the bathroom door.
  - (d) Write short notes on "Mouldings".

----- Cut here -----

2. Draft a 20' × 15' bedroom.
  - (a) Plan with furniture layout.
  - (b) One point perspective of the room.
  - (c) Write short notes on arches.
  - (d) Explain the plumbing fittings.

3. Draft a 9'0" × 9'0" kids bathroom.
- (a) Plan with furniture layout.
  - (b) One point perspective of the bedroom.
  - (c) Explain axometric projection with an example.
  - (d) Suggest wall finishes for the kids bedroom.

----- Cut here -----

4. Draft a 15'0" × 15'0" living room. Draw the following.
- (a) Plan with furniture layout.
  - (b) Two point perspective of the room.
  - (c) Explain the types of staircase.
  - (d) List the electrical fittings used in the room.

----- Cut here -----

5. Draft a master bedroom of 16' × 20'. Draw the following.
- (a) Plan with furniture layout.
  - (b) One point perspective of the room.
  - (c) Write about wall finishes.
  - (d) Draw electrical symbols.

**C-4636**

**Sub. Code**

**91933**

**B.Sc. DEGREE EXAMINATION**

**INTERIOR DESIGN**

**APRIL 2021 EXAMINATION**

**&**

**APRIL 2020 ARREAR EXAMINATION**

**Third Semester**

**CONSTRUCTION TECHNIQUES**

**(upto 2015 batch)**

Duration : 3 Hours

Maximum : 60 Marks

**Part A**

(5 × 2 = 10)

Answer **all** questions.

1. (a) Write about a functional requirements of a building.  
Or  
(b) How to draw foundation?
2. (a) Define damp proofing and give two effects of dampness.  
Or  
(b) What are the preventive measures for water proofing?
3. (a) What is stairs? Give any two technical terms of stairs.  
Or  
(b) Write note on ideal materials of damp proofing.

4. (a) Compare stone masonry and brick masonry.

Or

(b) Write about dimensions of bricks.

5. (a) Define Arch with a neat sketch.

Or

(b) List the types of brick masonry.

**Part B**

(5 × 10 = 50)

Answer **all** questions.

6. (a) Explain the components of the building with illustration.

Or

(b) Detailed note on plinth and super structure.

7. (a) Explain the cause and effects of dampers.

Or

(b) Detailed note on

(i) Ideal measures for damp proofing and

(ii) Reasons for water proofing.

8. (a) Explain types of stairs with neat sketch.

Or

(b) What are the types of materials and requirements for a good stair.

9. (a) Define stone masonry and materials required in detail.

Or

(b) Explain dressing of stone masonry with examples.

10. (a) Explain the technical terms of arches.

Or

(b) Describe dressing of stone for an arch and a front stair of a big house.

---

**C-4637**

**Sub. Code**

**91934**

**B.Sc. DEGREE EXAMINATION**

**INTERIOR DESIGN**

**APRIL 2021 EXAMINATION**

**&**

**APRIL 2020 ARREAR EXAMINATION**

**Third Semester**

**AUTOCAD I – PRACTICAL**

**(Upto 2015 batch)**

Duration : 3 Hours

Maximum : 60 Marks

**Part A**

**(6 × 5 = 30)**

Answer **all** questions.

1. Explain blocks.
2. Write a note on the ways of drawing a circle and arc.
3. Write a note on AutoCAD
4. Mention the types of Dimensions.
5. Explain Dimension style manager.
6. Explain object selection methods.

**Part B**

(3 × 10 = 30)

Answer **all** questions.

7. Explain modify tools.
  8. Draft a master bedroom plan with furniture 14' × 12'.
  9. Draft two sections of the master bedroom 14' × 12'.
-



**C-4638**

**Sub. Code**

**91935**

**B.Sc. DEGREE EXAMINATION**

**INTERIOR DESIGN**

**APRIL 2021 EXAMINATION**

**&**

**APRIL 2020 ARREAR EXAMINATION**

**Third Semester**

**DESIGN STUDIO I – PRACTICAL**

**(upto 2015 batch)**

Duration : 3 Hours

Maximum : 60 Marks

Answer **all** questions.

The examiner should cut and give one to each.

1. Draft a 'U' shaped kitchen 12' × 10'
  - (a) Plan with furniture layout
  - (b) Perspective view
  - (c) Circulation space
  - (d) Brief Island kitchen

----- Cut here -----

2. Draft a bedroom 12' × 14'
  - (a) Plan and furniture layout
  - (b) False ceiling layout
  - (c) Perspective view
  - (d) Brief carpets and rugs.

3. Draft a kids bed room  $10' \times 10'$
- (a) Plan and furniture layout.
  - (b) Sections (2)
  - (c) False ceiling layout
  - (d) Points to be considered for the selection of furniture in the kid's room.

----- Cut here -----

4. Draft a Modular kitchen  $10' \times 10'$
- (a) Plan and furniture layout
  - (b) Isometric view
  - (c) Sections (2)
  - (d) Mention the types of kitchen

----- Cut here -----

5. Draft a kitchen (L shaped)  $10' \times 9'$
- (a) Plan and furniture layout
  - (b) Perspective
  - (c) Circulation space
  - (d) Work triangle kitchen

\_\_\_\_\_

**C-4639**

**Sub. Code**

**91941**

**B.Sc. DEGREE EXAMINATION**

**INTERIOR DESIGN**

**APRIL 2021 EXAMINATION**

**&**

**APRIL 2020 ARREAR EXAMINATION**

**Fourth Semester**

**FURNITURE DESIGN**

**(Upto 2015 batch)**

Duration : 3 Hours

Maximum : 60 Marks

**Part A**

**(5 × 2 = 10)**

Answer **all** questions.

1. (a) Define joinery.

Or

(b) What is panelling?

2. (a) What are the types of partitions?

Or

(b) What are the types of joints.

3. (a) What is a load bearing partition?

Or

(b) Draft a stool (SCALE - 1:12)

4. (a) What is a kitchen triangle?

Or

(b) Sketch a side table.

5. (a) Sketch mortise and tenon.

Or

(b) Draw a single seater sofa.

**Part B**

(5 × 10 = 50)

Answer **all** questions.

6. (a) What are the principles governing the construction of joints?

Or

(b) Explain and sketch all the details of wood panelling.

7. (a) Explain fastenings in carpentry.

Or

(b) Draft a 'L' shaped kitchen in one point perspective.

8. (a) Explain bearing joints.

Or

(b) Explain oblique and shouldering joints and angle joints.

9. (a) Explain brick partition.

Or

(b) Explain metal partition and concrete partitions.

10. (a) Explain Victorian era furniture.

Or

(b) Sketch 6 contemporary furniture.

---

**C-4640**

**Sub. Code**

**91942**

**B.Sc. DEGREE EXAMINATION**

**INTERIOR DESIGN**

**APRIL 2021 EXAMINATION**

**&**

**APRIL 2020 ARREAR EXAMINATION**

**Fourth Semester**

**MATERIAL SCIENCE – II**

**(upto 2015 batch)**

Duration : 3 Hours

Maximum : 60 Marks

**Part A**

(5 × 2 = 10)

Answer **all** questions.

1. (a) What are the various commonly used building stones.

Or

- (b) Distinguish between Laterite and Sandstone.

2. (a) Give sketches of Single Scaffolding.

Or

- (b) Define shoring.

3. (a) Enumerate the general properties of Plastics.

Or

- (b) State the advantages of plywood.

4. (a) Mention the uses of Glass.

Or

(b) Give an introduction of Metals.

5. (a) Differentiate between Gable window and Dormer window.

Or

(b) Give sketches of Bay Window.

**Part B**

(5 × 10 = 50)

Answer **all** questions.

6. (a) What are the qualities of a good building stone.

Or

(b) Give classification, qualities, uses and localities of various types of stone available in India.

7. (a) Define Scaffolding and mention its component parts.

Or

(b) Explain what is meant by the term shoring and mention its types.

8. (a) What are the constituents of Plastics.

Or

(b) State the Market forms of Plywood and explain its types.

9. (a) Describe the various types of Glass.

Or

(b) Explain the different types of Metals.

10. (a) Give a list of different types of doors and windows with sketches.

Or

- (b) Give a list of fixtures and fastening which are commonly used for doors and windows.
-

**C-4641**

**Sub. Code**

**91943**

**B.Sc. DEGREE EXAMINATION**

**INTERIOR DESIGN**

**APRIL 2021 EXAMINATION**

**&**

**APRIL 2020 ARREAR EXAMINATION**

**Fourth Semester**

**BUILDING CONSTRUCTION**

**(Upto 2015 batch)**

Duration : 3 Hours

Maximum : 60 Marks

**Part A**

(5 × 2 = 10)

Answer **all** questions.

1. (a) List various uses of timber.

Or

(b) Write the advantages of timber construction.

2. (a) Write about framed structure in concrete.

Or

(b) What is soundness?

3. (a) What is centering?

Or

(b) Define roof.



4. (a) Write about objects of pointing.

Or

(b) What is ideal paint?

5. (a) What is form work?

Or

(b) Write about column form work.

**Part B**

(5 × 10 = 50)

Answer **all** questions.

6. (a) Explain the joinery techniques for ventilators and timber partitions with neat sketches.

Or

(b) Explain types and qualities of good timber.

7. (a) Explain the advantages of framed structures.

Or

(b) Write about concrete construction in doors and walls.

8. (a) Explain roof coverings for pitched roofs.

Or

(b) Describe ventilation of pitched roofs.

9. (a) What is pointing? What are its different types?

Or

(b) Explain different methods of plastering.

10. (a) Explain various types of centering.

Or

(b) Explain form work for column footings.

---

C-4642

Sub. Code

91944

**B.Sc. DEGREE EXAMINATION**

**INTERIOR DESIGN**

**APRIL 2021 EXAMINATION**

**&**

**APRIL 2020 ARREAR EXAMINATION**

**Fourth Semester**

**AUTOCAD II — PRACTICAL**

**(Upto 2015 batch)**

Duration : 3 Hours

Maximum : 60 Marks

Answer **all** the following.

1. Design a studio apartment for a woman lawyer who is in her late 20's.
  - (a) Draft the plan (5)
  - (b) Furniture layout (10)
  - (c) Sections (4 sections) (35)
  - (d) Isometric view (10)

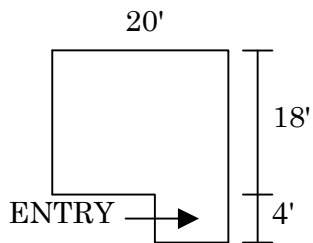

**C-3358**

**Sub. Code**

**91945**

**B.Sc. DEGREE EXAMINATION**

**INTERIOR DESIGN**

**APRIL 2021 EXAMINATION**

**&**

**APRIL 2020 ARREAR EXAMINATION**

**Fourth Semester**

**DESIGN STUDIO-II-PRACTICAL**

**(Up to 2015 Batch)**

Duration : 3 Hours

Maximum : 60 Marks

**Part A**

(2 × 5 = 10)

Answer **all** questions.

1. What are the parameters to be considered for designing an office space for a mobile show room?
2. Write brief note on commercial building.

**Part B**

(50)

Answer **all** questions

3. Draft the plan of 16' × 16' space for garment show room. Use 1:16 scale Add required furniture.
    - (a) Floor plan with furniture layout (1:16)
    - (b) Reflected ceiling plan (1:16)
    - (c) Two elevations with all the details of the finishes (1:12)
    - (d) Write about all materials used.
    - (e) Write about the colour use in the room.
-

**C-3359**

**Sub. Code**

**91951**

**B.Sc. DEGREE EXAMINATION**

**INTERIOR DESIGN**

**APRIL 2021 EXAMINATION**

**&**

**APRIL 2020 ARREAR EXAMINATION**

**Fifth Semester**

**BUSINESS MANAGEMENT**

**(Upto 2015 Batch)**

Duration : 3 Hours

Maximum : 60 Marks

**Part A**

(5 × 2 = 10)

Answer **all** questions by choosing either (a) or (b)

1. (a) What is administration?

Or

(b) Define scientific theory.

2. (a) List the advantages of planning.

Or

(b) Define forecasting.

3. (a) Write two types of line organization.

Or

(b) Write about informal organization.

4. (a) Describe supervision.  
Or  
(b) Write about motivation.
5. (a) Write about elements of control.  
Or  
(b) Write about delegation of authority.

**Part B**

(5 × 10 = 50)

Answer **all** questions by choosing either (a) or (b)

6. (a) Describe the various levels of management.  
Or  
(b) Explain Taylor's management approach.
7. (a) Explain the process of planning  
Or  
(b) Describe the types of planning.
8. (a) Explain the significance of directing.  
Or  
(b) Write in detail about supervision.
9. (a) Explain the process of controlling.  
Or  
(b) Explain various types of co-ordination.
10. (a) Write about decentralization of authority.  
Or  
(b) Explain principles of organization.

**C-3360**

**Sub. Code**

**91952**

**B.Sc. DEGREE EXAMINATION**

**INTERIOR DESIGN**

**APRIL 2021 EXAMINATION**

**&**

**APRIL 2020 ARREAR EXAMINATION**

**Fifth Semester**

**ESTIMATION AND COSTING**

**(Upto 2015 Batch)**

Duration : 3 Hours

Maximum : 60 Marks

**Part A**

(5 × 2 = 10)

Answer **all** questions.

1. (a) List the datas required to prepare an estimate.  
Or  
(b) What is lump sum?
2. (a) What is site plan?  
Or  
(b) Define specification.
3. (a) Write about labour contract.  
Or  
(b) What is overhead cost?
4. (a) What is depreciation?  
Or  
(b) Write about plinth area method.

5. (a) Name the types of quotation.

Or

(b) Write about importance of quotation.

**Part B**

(5 × 10 = 50)

Answer **all** questions, choosing either (a) or (b).

6. (a) Write about detailed estimate.

Or

(b) Explain various types of estimates.

7. (a) Discuss the concept of specifications in estimation and costing.

Or

(b) Explain typical specifications.

8. (a) Explain various forms of contract.

Or

(b) Explain schedule of prices contract.

9. (a) Explain purposes of valuation.

Or

(b) Discuss the need to check obsolescence.

10. (a) Explain the variables to be considered in fixing rates of materials and labor.

Or

(b) Explain rate analysis of typical items.



**C-4643**

**Sub. Code**

**91953**

**B.Sc. DEGREE EXAMINATION**

**INTERIOR DESIGN**

**APRIL 2021 EXAMINATION**

**&**

**APRIL 2020 ARREAR EXAMINATION**

**Fifth Semester**

**BUILDING SERVICES**

**(Upto 2015 batch)**

Duration : 3 Hours

Maximum : 60 Marks

**Part A**

**(5 × 2 = 10)**

Answer **all** questions.

1. (a) State the reasons for a building to catch fire.

Or

- (b) List any 3 rules for fire resisting buildings.

2. (a) What is reverberation.

Or

- (b) Mention the sound absorbent materials.

3. (a) Importance of electrical layout.

Or

- (b) Draw 3 electrical symbols.

4. (a) Mention the factors affecting ventilation.

Or

(b) Define ventilation.

5. (a) What are the types of air conditioning.

Or

(b) Design a plan of a bathroom.

**Part B**

(5 × 10 = 50)

Answer **all** questions.

6. (a) Explain the properties of fire resisting properties of building materials.

Or

(b) Explain fire protection.

7. (a) What are the factors to be considered for the acoustical design of a conference room.

Or

(b) Explain acoustics.

8. (a) Explain air conditioning.

Or

(b) Explain ventilation.

9. (a) Explain the purpose and filters of air conditioning.

Or

(b) Brief the conditions of acoustics for designing a hall for commercial purpose.

10. (a) Design an electrical layout for a residential building.

Or

(b) Design an electrical layout for a retail store.

---

**C-4644**

**Sub. Code**

**91954**

**B.Sc. DEGREE EXAMINATION**

**INTERIOR DESIGN**

**APRIL 2021 EXAMINATION**

**&**

**APRIL 2020 ARREAR EXAMINATION**

**Fifth Semester**

**AUTOCAD 3 – PRACTICAL**

**(upto 2015 batch)**

Duration : 3 Hours

Maximum : 60 Marks

**Part A** (10)

1. Design and draw the plan of refreshment based on theme forest. Assume the necessary details.

**Part B** (50)

Answer **all** questions.

2. Draw the following of a college building.
    - (a) Floor plan
    - (b) Furniture layout
    - (c) Front elevation
    - (d) Electrical layout
    - (e) Cross-section.
-

**C-4645**

**Sub. Code**

**91955**

**B.Sc. DEGREE EXAMINATION**

**INTERIOR DESIGN**

**APRIL 2021 EXAMINATION**

**&**

**APRIL 2020 ARREAR EXAMINATION**

**Fifth Semester**

**DESIGN STUDIO III – PRACTICAL**

**(Upto 2015 batch)**

Duration : 3 Hours

Maximum : 60 Marks

**Part A**

(2 × 10 = 20)

Answer **all** questions.

1. Design a layout with provision to set up a hospital unit of capacity of 50 bedded capacity.
2. Give the layout design, space requirement for a college.

**Part B**

(2 × 20 = 40)

Answer **all** questions.

3. Designing a shopping centre which will be having multiplex theatres of 8 numbers, swimming pool, restaurant of two numbers, shop - 10 numbs. The centre is provided with ultra modern facility having car parking elevators etc and also the complex is fully air conditioned.
  4. Design a layout and give the plan for a 100 machine apparel industry.
-

**C-3361**

**Sub. Code**

**91961**

**B.Sc. DEGREE EXAMINATION**

**INTERIOR DESIGN**

**APRIL 2021 EXAMINATION**

**&**

**APRIL 2020 ARREAR EXAMINATION**

**Sixth Semester**

**LAND SCAPE DESIGN**

**(Upto 2015 Batch)**

Duration : 3 Hours

Maximum : 60 Marks

**Part A**

(5 × 2 = 10)

Answer **all** questions.

1. (a) Define landscaping.

Or

(b) What is soft landscape?

2. (a) What is carbon sink?

Or

(b) How plant materials are classified?

3. (a) Highlight the benefits of green design.

Or

(b) What is crop improvement?

4. (a) List two important factors to be considered in site investigation.

Or

- (b) What is desic study?

5. (a) What are the functional areas of land scaping?

Or

- (b) List out any four types of landscaping.

**Part B** (5 × 10 = 50)

Answer **all** questions, choosing either (a) or (b).

6. (a) Explain colonial theme in landscaping.

Or

- (b) Explain in detail about landscape conservation with respect to man and plants.

7. (a) Explain in detail the plant selection process with respect to landscaping.

Or

- (b) Discuss in detail about different planting design in landscaping.

8. (a) Explain in detail about basic principles of land scape design.

Or

- (b) Describe in detail Moghul gardening principles.

9. (a) Explain the site investigation appraisal process for constructing toilets.

Or

- (b) Explain the importance of analyzing the neighbouring environment in land scape design.

10. (a) Explain the landscaping of favor house.

Or

(b) Explain the landscaping of flats.

---



**C-3362**

**Sub. Code**

**91962**

**B.Sc. DEGREE EXAMINATION**

**INTERIOR DESIGN**

**APRIL 2021 EXAMINATION**

**&**

**APRIL 2020 ARREAR EXAMINATION**

**Sixth Semester**

**SCIENCE OF VAASTU**

**(Up to 2015 Batch)**

Duration : 3 Hours

Maximum : 60 Marks

**Part A**

(5 × 2 = 10)

Answer **all** questions, by choosing either (a) or (b).

1. (a) What are the types of Vaastu?

Or

(b) State the importance of Vaastu.

2. (a) List out any two positive energies in a building.

Or

(b) What is material space?

3. (a) Where should be study room located in a building as per Vaastu?

Or

(b) Give any two hints on planning based on Vaastu.

4. (a) What is important parameter in Vaastu for back door if the building is east facing?

Or

- (b) Relate Vaastu with direction of building.

5. (a) Name the ancient principles of Vaastu.

Or

- (b) Brief about Feng Shui.

**Part B**

(5 × 10 = 50)

Answer **all** questions, choosing either (a) or (b).

6. (a) Discuss about Vaastu Purusha mandala and its significance.

Or

- (b) Explain about various classification of Vaastu.

7. (a) Elaborate on the relationship between living organism and built space.

Or

- (b) Describe about positive and negative energies.

8. (a) Give a detailed note on important hints on planning on Vaastu.

Or

- (b) Explain about location of Pooja room in a house based on Vaastu.

9. (a) Explain the Vaastu parameters for a East facing building.

Or

(b) Demonstrate the remedies for South facing house as per Vaastu.

10. (a) Explain the principle of Feng-Shui.

Or

(b) Discuss the principle of Feng-Shui for offices.

---

**C-3363**

**Sub. Code**

**91963**

**B.Sc. DEGREE EXAMINATION**

**INTERIOR DESIGN**

**APRIL 2021 EXAMINATION**

**&**

**APRIL 2020 ARREAR EXAMINATION**

**Sixth Semester**

**HUMAN RESOURCE MANAGEMENT**

**(Upto 2015 Batch)**

Duration : 3 Hours

Maximum : 60 Marks

**Part A**

(5 × 2 = 10)

Answer **all** questions by choosing either (a) or (b).

1. (a) High light the objectives of personnel management.

Or

- (b) What is the importance of human resource management in an industry?

2. (a) What is staffing?

Or

- (b) List the types of interview.

3. (a) What are performance dimensions?

Or

- (b) What is performance appraisal?

4. (a) What is the purpose of providing incentives?

Or

(b) List types of incentives.

5. (a) Define counseling.

Or

(b) What is retention profile?

**Part B**

(5 × 10 = 50)

Answer **all** questions, choosing either (a) or (b).

6. (a) Discuss in detail about the characteristics required for a successful personnel manager.

Or

(b) Explain the role of a personnel manager.

7. (a) Explain the various steps in recruitment process.

Or

(b) Explain the importance of job analysis.

8. (a) Explain the types of training provided to employees?

Or

(b) Discuss the different factors affecting the performance appraisal.

9. (a) Explain the types of motivation process.

Or

(b) Explain the various steps to increase productivity.

10. (a) Explain the measurement of labor turnover.

Or

(b) Explain the theoretical model of counseling process.